

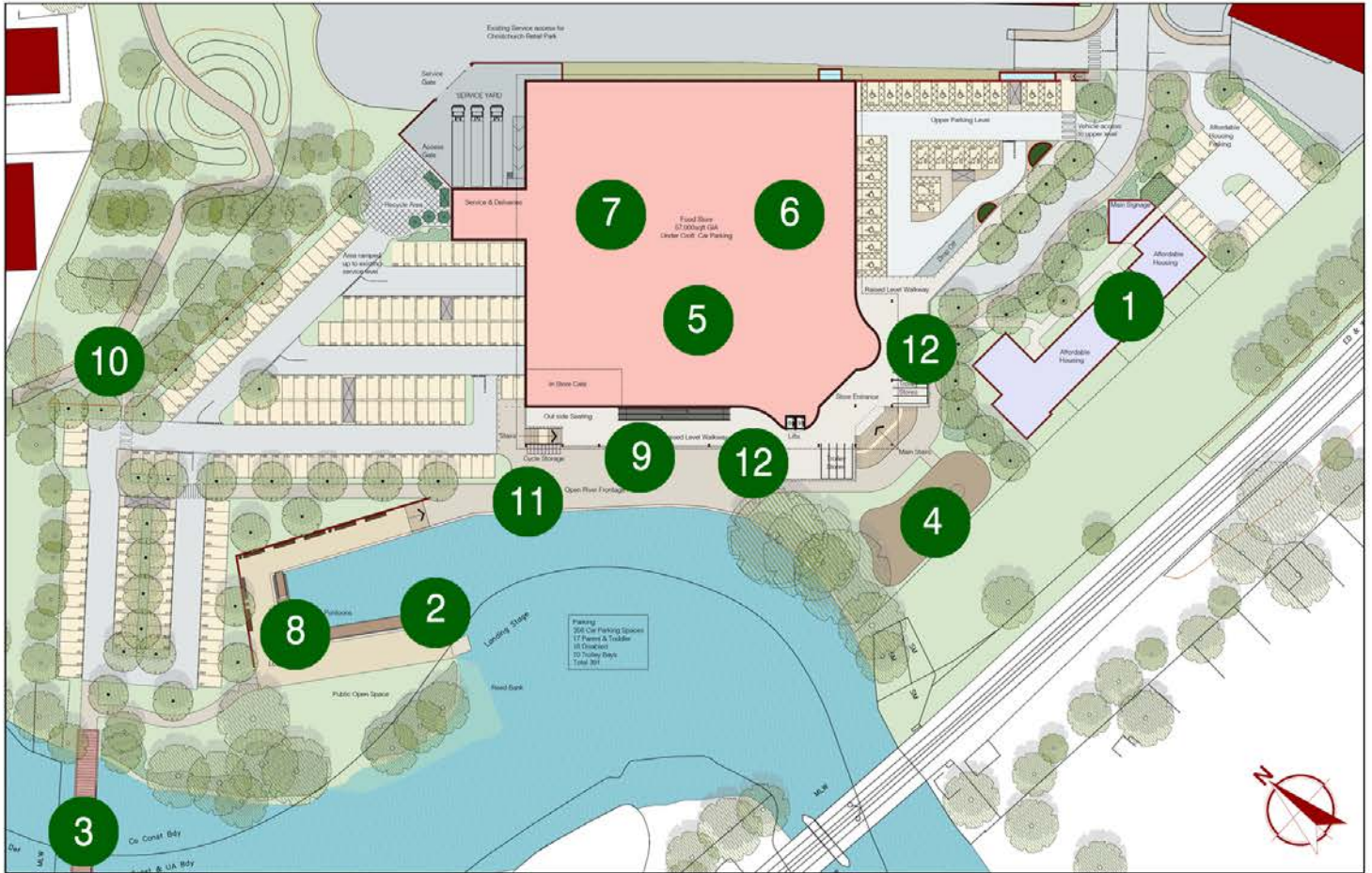

# Bailey Drive, Christchurch Proposed Mixed Use Development



Not to any scale, for identification purposes only

## Quantum's Mixed Use Development provides these notable community *benefits*



1) Affordable Housing



2) Ferry Link to Town Centre



3) Pedestrian bridge over River



4) Play Park for community



5) Foodstore



6) Creation of 300+ New Jobs



7) Gym / Fitness Centre



8) Access to the River Stour



9) Public Art



10) Extensions to existing cycle lane



11) River Front Open Space



12) Town Centre Information boards